

REVISION RECORD		
REV	DESCRIPTION	DATE
A/0		2007/08/10
A/1	Update edition	2008/06/05
A/2	△ $\phi 2.8$ 改为 $\phi 2.7$	2013/03/10
	△ $\phi 3.0$ 改为 $\phi 2.9$	2013/03/10

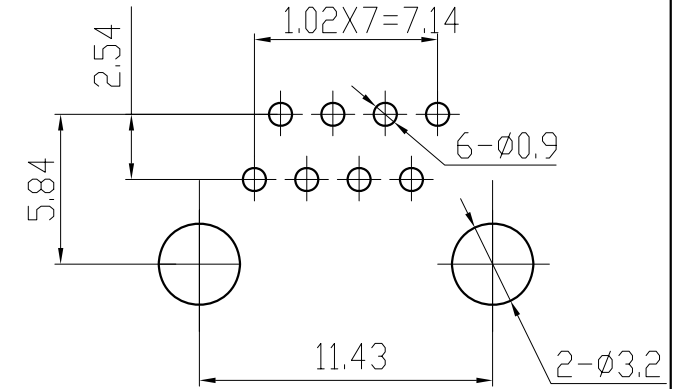

PC Board Layout

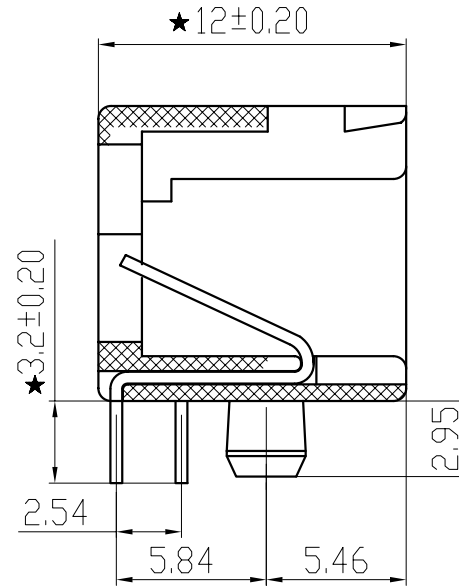
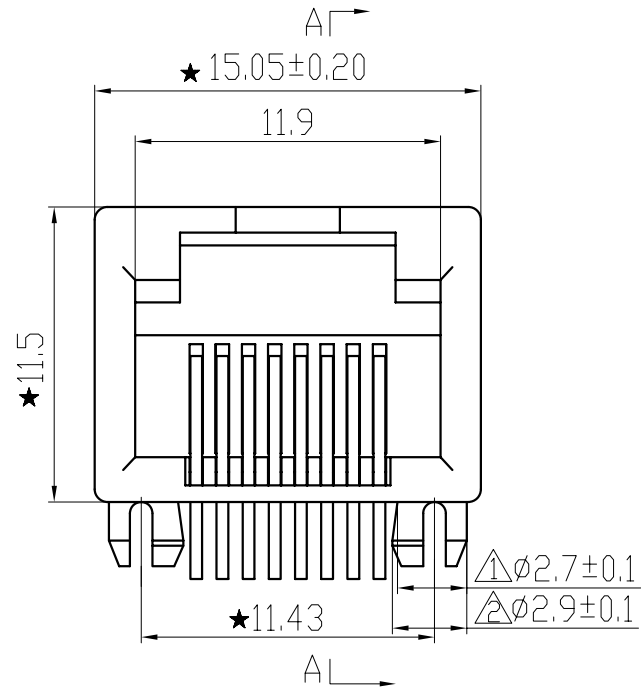
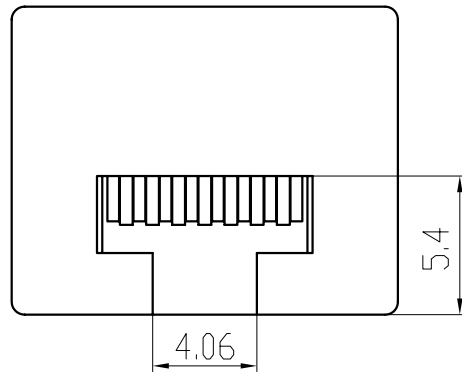

NOTES:

ELECTRICAL:

1. VOLTAGE RATING : 125 VAC RMS.
2. CURRENT RATING : 1.5 AMP.
3. CONTACT RESISTANCE : 30 MILLIOHMS MAX.
4. INSULATION RESISTANCE : 500 MEGOHMS MIN @ 500 VDC.
5. DIELECTRIC STRENGTH : 1000 VAC RMS 50Hz or 60Hz, 1MIN.

MECHANICAL:

1. HOUSING & INSERT MATERIAL : PBT UL94V-0.
2. CONTACT MATERIAL : DIAMETER 0.45MM PHOSPHOR BRONZE GOLD PLATING OVER NICKEL.
3. MATING/UNMATING FORCE : 2.2KG.F MAX.
4. RETENTION STRENGTH : 7.7KG.F MIN BETWEEN JACK AND PLUG.
5. OPERATING LIFE : 600 CYCLES MIN.

ENVIRONMENTAL:

1. STORAGE : -10°C ~ +40°C RELATIVE HUMIDITY<70%.
2. OPERATION : -40°C ~ +85°C.

Remark:

1. Tolerances Unless Otherwise Specified
 $.0 \pm 0.25$ $.00 \pm 0.20$ $.000 \pm 0.10$
2. The mark with ★ is the key inspection dimension for QC

TELL			Coorle		库乐科技		
Fax							
Units	MM	Drawing			Material	Name	
Scale	1 : 1	Check					
Rev'	A / 1	Approval			HOUSING	PBT	Part Number
View		Date	2008/06/05	PIN	Qsn6.5-0.1	File Name	